

## HD 9/20-4 S ST CLASSIC

As robust as it is powerful: the HD 9/20-4 S St Classic stationary cold water high-pressure cleaner for tough cleaning applications. Assembly, operation and maintenance that is so effortless, it's child's play.



Order no.

1.367-410.0

- Air/water-cooled, 4-pole low-speed motor
- Easy installation, operation and maintenance of the machine

### Technical data

EAN code		4054278967417
Supply voltage	Ph / V / Hz	3 / 376 - 424 / 50
Flow rate	l/h	450 - 900
Inlet temperature	°C	60
Working pressure	bar	50 - 200
Max. pressure	bar	260
Connected load	kW	7
Power cable	m	5
Nozzle size		047
Water inlet		1"
Weight (with accessories)	kg	49.7
Weight incl. packaging	kg	55.4
Dimensions (L × W × H)	mm	720 × 522 × 418

Users must receive training on this device.

### Equipment

High-pressure hose	m	10 / ID 8, 315 bar
Spray lance	mm	840
Power nozzle		■
Crankshaft pump with ceramic pistons		■
4-pole, three-phase motor with air and water cooling		■
Pressure switch-off		■
Integrated water fine filter		■
High-pressure spray lance		■
Oil level indicator		■
Brass water inlet		■

■ included in the scope of supply.

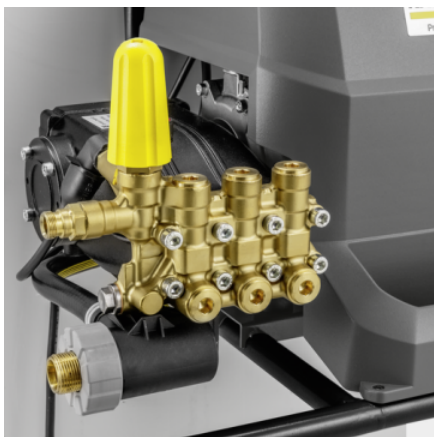

## Powerful and robust crankshaft pump with brass cylinder head and pistons with ceramic sleeves

- High performance and high efficiency.
- Long service life and low maintenance costs.
- With suction feature and up to 60 °C water temperature.



## Robust, stationary chassis

- A robust tubular steel frame reliably protects the machine against damage.
- Long-lasting, robust and thus very economical machine.
- The sturdy pipe frame provides protection in continuous heavy-duty use.



## Classic accessories with EASY!Lock connections

- Robust and durable accessories.
- Quick set-up and pack-up plus easy accessory replacement.
- Easy to use

## ACCESSORIES FOR HD 9/20-4 S ST CLASSIC

### 1.367-410.0

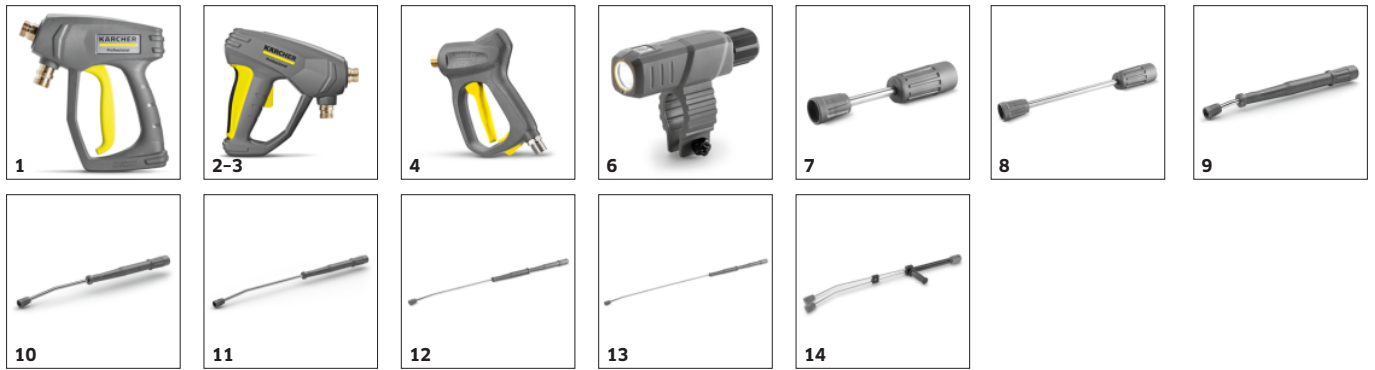

	Order no.	Description	
<b>TRIGGER GUNS</b>			
<b>Spray guns</b>			
Pistol TR 155°C with package	1	4.119-002.0	High-quality Classic spray gun with robust valve. Also suitable for Kärcher hot water high-pressure cleaners. ■
EASY!Force Advanced	2	4.118-005.0	Effortless, not energy-sapping: the EASY!Force high-pressure gun uses the recoil force of the high-pressure jet to reduce the holding force for the operator to zero. □
EASY!Force Food	3	4.118-015.0	Perfect for the food industry: the EASY!Force high-pressure gun with full ceramic valve enables fatigueless working due to virtually zero holding force for the operator. □
High-End HD Trigger Gun	4	4.118-011.0	Robust, durable high-end spray gun for use in the food industry and industry. Very low pressure loss - even with water volumes up to 2500 l/h. □
<b>SPRAY LANCES</b>			
<b>Rotating spray lances</b>			
Jet pipe with transport packaging, 840 mm	5	4.119-003.0	Rotating Classic spray lance with ergonomic handle bowls in a robust and high-quality stainless steel design. Also suitable for Kärcher hot water high-pressure cleaners. ■
LED nozzle light	6	2.680-002.0	Bright, lightweight LED work light for direct mounting on spray lance of EASY!Force high-pressure gun. Better view in unfavourable lighting conditions for up to 5 working hours. □
Spray lance, 250 mm, rotatable	7	4.112-027.0	Spray lance, 250 mm, rotatable, ergonomic □
Spray lance, 400 mm, rotatable	8	4.112-024.0	Spray lance, 400 mm, rotatable, ergonomic □
Spray lance, 600 mm, rotatable	9	4.112-007.0	600 mm stainless steel lance (manual coupling) with ergonomic handle for ease of use and protection. Rotatable 360° under pressure. □
Spray lance, 840 mm, rotatable	10	4.112-006.0	850 mm stainless steel lance (manual coupling) with ergonomic handle for ease of use and protection. Rotatable 360° under pressure. □
Spray lance, 1050 mm, rotatable	11	4.112-000.0	1050 mm stainless steel lance (manual coupling) with ergonomic handle for ease of use and protection. Rotatable 360° under pressure. □
Spray lance, 1550 mm, rotatable	12	4.112-018.0	1550 mm stainless steel lance (manual coupling) with ergonomic handle for ease of use and protection. Rotatable 360° under pressure. □
Spray lance, 2050 mm, rotatable	13	4.112-021.0	2050 mm stainless steel lance (manual coupling) with ergonomic handle for ease of use and protection. Rotatable 360° under pressure. □
<b>Double lance</b>			
Double lance, 960 mm	14	2.112-016.0	960 mm double lance for variable pressure adjustment on handle at full water flow rate. Suitable for agricultural use ( e.g. stable cleaning). □

■ Included in the scope of supply. □ Available accessories.

## ACCESSORIES FOR HD 9/20-4 S ST CLASSIC

### 1.367-410.0



		Order no.	Description	
<b>SPRAY LANCES</b>				
<b>Flexible spray lance</b>				
Flexible lance, 1050 mm	15	4.112-035.0	1050 mm flexible lance with variable bend from 20° to 140°, ideal for cleaning difficult to reach areas, e.g. gutters.	<input type="checkbox"/>
High pressure articulated joint	16	4.112-057.0	For hard-to-reach areas: High-pressure articulated joint with infinite angle adjustment up to 120°. Simply attach directly to the spray lance of the pressure washer.	<input type="checkbox"/>
<b>Undercarriage spray lance</b>				
Underbody lance	17	4.112-032.0	Stainless steel lance for effective and easy underbody and wheel arch cleaning. Without high-pressure nozzle.	<input type="checkbox"/>
<b>Additional handle</b>				
Additional handle for EASY!Lock spray lances	18	4.321-380.0	Comfortable in every situation – the additional handle is easy to attach to the spray lance of our new EASY!Lock generation and makes work easier by allowing you to adjust your posture to suit the particular task. Regularly changing your posture relieves the strain on your body, making work more relaxed. Thanks to the 360°-rotatable spray lance, the additional handle can simply be fully rotated whilst working for greater flexibility.	<input type="checkbox"/>
<b>KÄRCHER POWER NOZZLE</b>				
<b>Power nozzle spray angle 25°</b>				
Power nozzle 25°, 047	19	2.113-009.0	Fan jet nozzle with 25° spray angle, suitable for large areas and removing stubborn dirt and stains.	<input checked="" type="checkbox"/>
Power nozzle 25°, 052	20	2.113-024.0		<input type="checkbox"/>
Power nozzle , 055	21	2.113-025.0	Flat jet nozzle for large area performance and stubborn dirt.	<input type="checkbox"/>
Power nozzle , 060	22	2.113-026.0	Fan jet nozzle for large-area coverage and stubborn dirt and stains.	<input type="checkbox"/>
<b>HP nozzle spray angle 0°</b>				
Power nozzle 0°, 050	23	2.113-034.0	High-pressure nozzle with powerful jet for extremely stubborn dirt.	<input type="checkbox"/>
Power nozzle 0°, 055	24	2.113-035.0		<input type="checkbox"/>
<b>Power nozzle spray angle 15°</b>				
Power nozzle 15°, 055	25	2.113-047.0	Fan jet nozzle with 15° spray angle suitable for stubborn dirt.	<input type="checkbox"/>
<b>Power nozzle spray angle 40°</b>				
Power nozzle 40°, 050	26	2.113-054.0	Power nozzle with a 40° spray angle and fan jet, suitable for large areas and sensitive surfaces.	<input type="checkbox"/>
<b>NOZZLE UNION / SPACER</b>				
<b>Nozzle union</b>				
Nozzle screws	27	4.112-011.0	Nozzle screws with protectors for high-pressure and power nozzles	<input checked="" type="checkbox"/>
<b>ROTARY NOZZLES (DIRT BLASTERS)</b>				
<b>Dirt blaster, large</b>				
Dirt blaster, large, 050	28	4.114-027.0	The dirt blaster with rotating pencil jet offers 10 times better cleaning performance. Ceramic nozzle and bearing ring for a long service life. Further data: Max. 300 bar, 30 MPa, 85°C.	<input type="checkbox"/>

■ Included in the scope of supply. □ Available accessories.

## ACCESSORIES FOR HD 9/20-4 S ST CLASSIC

### 1.367-410.0



		Order no.	Description	
<b>ROTARY NOZZLES (DIRT BLASTERS)</b>				
<b>Dirt blaster, large</b>				
Dirt blaster Vibrasoft, 050	29	4.114-066.0	Vibrasoft rotary nozzle with rotating point jet for ten times greater cleaning performance. Durable dirt blaster thanks to ceramic nozzle. Reduces vibrations by up to 30% for maximum ergonomics.	<input type="checkbox"/>
<b>HIGH-PRESSURE HOSES</b>				
<b>Standard with unions on both sides</b>				
High-pressure hose, 10 m, DN 8, 315 bar, 2 × EASY!Lock	30	6.110-031.0	High-pressure hose (DN 8) suitable up to 315 bar pressure. With innovative EASY!Lock manual screw fitting on both sides, ANTI!Twist and 10 m long.	<input type="checkbox"/>
High-pressure hose, 15 m, DN 8, 315 bar, 2 × EASY!Lock	31	6.110-030.0	15 m long high-pressure hose, DN 8, with ANTI!Twist and time-saving EASY!Lock manual screw fitting on both sides.	<input type="checkbox"/>
High-pressure hose, 20 m, DN 8, 315 bar, 2 × EASY!Lock	32	6.110-032.0	20 m long high-pressure hose (DN 8) equipped with the time-saving and robust EASY!Lock manual screw fitting on both sides. Approved for pressures up to 315 bar.	<input type="checkbox"/>
<b>Longlife 400 with unions on both sides</b>				
High-pressure hose Longlife, 1,5 m, DN 8, 400 bar, 2 × EASY!Lock	33	6.110-024.0	1,5 m short high-pressure hose (DN 8). Comfortable EASY!Lock manual screw fitting on both sides for robust and quick connections. Durable and designed for up to 400 bar pressure.	<input type="checkbox"/>
High-pressure hose Longlife, 1,5 m, DN 8, 400 bar, 1 × EASY!Lock / 1 × M22 × 1,5	34	6.110-069.0	1,5 m long high-pressure hose (DN 8) suitable for up to 400 bar pressure with double steel core. Connections: M 22 × 1,5, as well as the comfortable and quick EASY!Lock manual screw fitting.	<input type="checkbox"/>
High-pressure hose Longlife, 1,5 m, DN 8, 400 bar, 2 × M22 × 1,5	35	6.390-178.0	1,5 m high-pressure hose (DN 8, M 22 × 1,5) with kink protection and connectors at both ends. For connecting to hose reels with appropriate connector (M 22 × 1,5).	<input type="checkbox"/>
High-pressure hose Longlife, 10 m, DN 8, 400 bar, 2 × EASY!Lock	36	6.110-038.0	Durable, 10 m long high-pressure hose (DN 8) with double steel core and EASY!Lock manual screw fitting on both sides and ANTI!Twist. Approved for 400 bar pressure.	<input type="checkbox"/>
High-pressure hose Longlife, 30 m, DN 8, 400 bar, 2 × EASY!Lock	37	6.110-023.0	Robust high-pressure hose with double steel core, ANTI!Twist and EASY!Lock manual screw fitting on both sides. Nominal size DN 8, 30 m long, for up to 400 bar pressure.	<input type="checkbox"/>
High-pressure hose Longlife, 20 m, DN 8, 400 bar, 2 × EASY!Lock	38	6.110-027.0	High-pressure hose with ANTI!Twist, EASY!Lock manual screw fittings and double steel core. 20 m long, nominal size DN 8, EASY!Lock manual screw fitting on both sides.	<input type="checkbox"/>
High-pressure hose Longlife, 15 m, DN 8, 400 bar, 2 × EASY!Lock	39	6.110-029.0	The double steel core ensures a particularly long life of this 15 m long high-pressure hose (DN 8), which is approved for pressures up to 400 bar.	<input type="checkbox"/>
<b>Food industry version with unions on both sides</b>				
High-pressure hose food grade, 10 m, DN 8, 250 bar, 2 × EASY!Lock	40	6.110-051.0	High-pressure hose (ID 6), 10 m long, with grey, non-marking outer covering. Approved for use in the food industry. With quick and robust EASY!Lock hand screw connection at both ends.	<input type="checkbox"/>
High-pressure hose food grade, 20 m, DN 8, 250 bar, 2 × EASY!Lock	41	6.110-052.0	Suitable for use in food industry: 20 m long high-pressure hose (ID 8) with grey, non-marking outer covering, ANTI!Twist and EASY!Lock hand screw connections.	<input type="checkbox"/>
<b>Longlife food design with screw connections at both ends</b>				
High-pressure hose food grade Longlife, 10 m, DN 8, 400 bar, 2 × EASY!Lock	42	6.110-053.0	With blue, non-marking and animal fat resistant outer covering: durable high-pressure hose (ID 8), 10 m long, ANTI!Twist and EASY!Lock hand screw connection at both ends.	<input type="checkbox"/>

■ Included in the scope of supply. □ Available accessories.

## ACCESSORIES FOR HD 9/20-4 S ST CLASSIC

### 1.367-410.0



		Order no.	Description	
<b>HIGH-PRESSURE HOSES</b>				
<b>Longlife food design with screw connections at both ends</b>				
High-pressure hose food grade Longlife, 20 m, DN 8, 400 bar, 2 × EASY!Lock	43	6.110-054.0	Durable high-pressure hose with double steel reinforcement and blue, non-marking and animal fat resistant outer covering. 20 m long with EASY!Lock hand screw connections.	<input type="checkbox"/>
<b>Special hoses</b>				
High-pressure hose curved, 1.5 m, DN 8, 400 bar, 1 × EASY!Lock / 1 × M22 × 1.5	44	6.110-068.0	For connection to hose reels: high-pressure hose, with M 22 × 1.5 connection and curved EASY!Lock hand screw connection. 1.5 m long, suitable for up to 400 bar working pressure.	<input type="checkbox"/>
<b>PIPE CLEANING</b>				
<b>Pipe cleaning hose, ID 6</b>				
Pipe cleaning hose, ID 6, 10 m, max. 250 bar	45	6.110-046.0	The 10 m pipe cleaning hose is a highly flexible high pressure hose for pipe interior cleaning (threaded connection for nozzle R 1/8).	<input type="checkbox"/>
Pipe cleaning hose, ID 6, 20 m, max. 250 bar	46	6.110-008.0	The 20 m pipe cleaning hose is a highly flexible high pressure hose for pipe interior cleaning (threaded connection for nozzle R 1/8).	<input type="checkbox"/>
Pipe cleaning hose, ID 6, 30 m, max. 250 bar	47	6.110-047.0	The 30 m pipe cleaning hose is a highly flexible high pressure hose for pipe interior cleaning (threaded connection for nozzle R 1/8).	<input type="checkbox"/>
<b>Pipe cleaning nozzle</b>				
Pipe cleaning dirt blaster D21/060	48	4.765-002.0	The forward-tilted rotating pencil jet removes the most stubborn dirt. The three backwards-tilted jets ensure the necessary forward movement, as well as convenient handling.	<input type="checkbox"/>
Pipe cleaning dirt blaster D30/060	49	4.765-005.0		<input type="checkbox"/>
Pipe cleaning nozzle 080	50	5.763-087.0	Pipe cleaning nozzle with 24 mm diameter. With 4 nozzles tilted back at a 30° angle.	<input type="checkbox"/>
Pipe cleaning nozzle	51	5.763-015.0	16 mm pipe cleaning nozzle with internal thread. Various jet directions for environmentally-friendly cleaning of blocked drains and pipes.	<input type="checkbox"/>
	52	5.763-019.0		<input type="checkbox"/>
	53	5.763-016.0		<input type="checkbox"/>
	54	5.763-021.0		30 mm pipe cleaning nozzle with internal thread. Various jet directions for environmentally-friendly cleaning of blocked drains and pipes.
Rotating pipe cleaning nozzle	55	6.415-428.0	Pipe cleaning nozzle with four rotating jets and inner thread. Different spray directions. The hose moves freely through the pipe. With R 1/8" connection.	<input type="checkbox"/>
	56	6.415-440.0	Rotating pipe cleaning nozzle with internal thread and four rotating jets for environmentally-friendly cleaning of blocked drains and pipes.	<input type="checkbox"/>

Available accessories.

## ACCESSORIES FOR HD 9/20-4 S ST CLASSIC 1.367-410.0



		Order no.	Description	
<b>FLOOR AND HARD SURFACE CLEANER</b>				
<b>FR 30 Me surface cleaner</b>				
Hard surface cleaner FR 30 Me	57	2.640-355.0	Hot water resistant stainless steel surface cleaner with double ceramic bearings, non-marking swivel castors and suction hose connection. Ideal for indoor cleaning, e.g. food industry.	<input type="checkbox"/>
<b>Hard Surface Cleaner FR 50</b>				
Hard surface cleaner FR 50	58	2.640-679.0	Hot water resistant stainless steel surface cleaner with 500 mm working width. Ideal for large areas. With double ceramic bearings, push handle, non-marking swivel castors and detergent dosing system.	<input type="checkbox"/>
Surface Cleaner FR 50 Me	59	2.111-023.0		<input type="checkbox"/>
<b>Machine-specific nozzle kits for FR</b>				
Nozzle kit for FR, 850 l/h - 1100 l/h	60	2.640-442.0	Nozzle kit includes power nozzles and unions. For Kärcher surface cleaners (850 to 1100 l/h).	<input type="checkbox"/>
<b>FOAM SYSTEMS</b>				
<b>Cup foam lance</b>				
Cup foam lance Basic 3, 900 l/h - 2500 l/h	61	4.112-055.0	High-quality, simple and durable: Basic 3 cup foam lance for high-pressure cleaners with a flow rate of 900-2500 l/h. Halves the cleaning agent consumption while maintaining optimum foam quality.	<input type="checkbox"/>
Cup foam lance Advanced 3, 900 l/h - 2500 l/h	62	4.112-065.0	Specially designed for use with aggressive cleaning agents: High-quality cup foam lance Advanced 3 with spray angle adjustment and Eco brass for high-pressure cleaners from Kärcher.	<input type="checkbox"/>
Cup foam lance DUO Advanced 3, 900 l/h - 2500 l/h	63	4.112-069.0	DUO Advanced 3 cup foam lance, designed for use with aggressive detergents. With instant switching to high-pressure cleaning, spraying angle adjustment and two-litre tank.	<input type="checkbox"/>
<b>Inno Foam Kit</b>				
Inno Foam Set with detergent injector	64	2.112-000.0	High-pressure foam system with double lance (foam nozzle and high-pressure jet for rinsing). For use with mobile and stationary high-pressure and HDS pressure cleaners for cleaning or disinfection.	<input type="checkbox"/>
Inno Foam Set	65	2.112-008.0		<input type="checkbox"/>
<b>Easy Foam Set</b>				
Easy Foam Set with RM injector	66	2.112-010.0	HP foam system for use with HD/HDS units for cleaning and disinfecting. Foam nozzle for connection to lance and HP chemical injector with precision 0-5% metering valve. The machine specific nozzle kit has to be ordered separately.	<input type="checkbox"/>
<b>Nozzle kits for Inno/Easy Foam Set</b>				
Nozzle kit 090 for Inno / Easy Set 700-1,000 l/h	67	2.111-019.0	Nozzle kit contains Kärcher power nozzles and nozzle inserts. For Inno/Easy-Foam set 700-1000 l/h. For optimal foam system performance.	<input type="checkbox"/>
<b>Foam nozzle mounting kit</b>				
Foam nozzle attachment kit	68	2.112-013.0	Foaming agent kit. The foam nozzle is ideal for use in sanitary areas and the food industry and wherever long application times are necessary.	<input type="checkbox"/>
<b>MIXERS AND INJECTORS</b>				
<b>Cleaning agent injector</b>				
Stainless steel injector kit for HD 9/20-4M	69	6.645-760.0	For a working pressure of 300 bar at 95°C water temperature, this stainless steel injector was developed specifically for the HD 9/20-4 M high-pressure cleaner. With suction hose and vacuum filter.	<input type="checkbox"/>
Cleaning agent injector for high pressure (without nozzle)	70	4.637-033.0	Cleaning agent dosage at high pressure 3 - 5 %	<input type="checkbox"/>

Available accessories.



## ACCESSORIES FOR HD 9/20-4 S ST CLASSIC

### 1.367-410.0



	Order no.	Description	
<b>MIXERS AND INJECTORS</b>			
<b>Machine-specific nozzle kit with order no. 4.637-033.0</b>			
Nozzle kit 750-1000 l/h	71	4.769-011.0	For HD/HDS 750 - 1000 l/h. Consists of nozzle insert + HP power nozzle + union <input type="checkbox"/>
<b>COUPLING PARTS</b>			
<b>Connector</b>			
Y distributor	72	4.111-024.0	Offers the option to connect two spray units to the machine. Installation on the high pressure outlet. <input type="checkbox"/>
Short spray unit	73	4.111-038.0	For attaching high-pressure nozzles and accessory parts to HP trigger gun (with nozzle screws). Not compatible with triple nozzles. <input type="checkbox"/>
<b>EASY!Lock adapter</b>			
Adapter 2 M22IG-TR22AG	74	4.111-030.0	Adapter 2 to connect the old device with the new hose and the old gun with the new hose <input type="checkbox"/>
Adapter 6 TR22IG-M22AG	75	4.111-034.0	Adapter 6 to connect the new device with the old hose and the old hose with the new gun <input type="checkbox"/>
Adapter hose extension 9 TR	76	4.111-037.0	Adapter 9 to connect the new hose with the new hose <input type="checkbox"/>
<b>HOSE REELS</b>			
<b>Automatic, self-winding hose reels for wall mounting</b>			
Automatic hose reel, powder-coated steel / plastic, 20 m	77	6.392-074.0	Automatic hose reel for 20 m high-pressure hose. The console is made from powder-coated steel, the drum is made from plastic. <input type="checkbox"/>
Automatic stainless steel / synthetic material hose drum, 20 m	78	6.392-083.0	Automatic hose reel for 20 m high-pressure hose. The console consists of stainless steel, the drum is made from plastic. <input type="checkbox"/>
Automatic hose reel, coated, 20 m	79	6.392-106.0	Automatic hose reel of durable plastic. Painted steel bracket. Suitable for 20 m high-pressure hose. <input type="checkbox"/>
Hose reel, automatic, basalt grey-coated, 20 m	80	6.392-105.0	Automatic hose reels provide the highest level of safety and convenience for winding and unwinding HP hoses. For example: order no. 6.110-011.0 (ID 8, 20 m, 315 bar) or order no. 6.110-028.0 (ID 8, 20 m, 400 bar Longlife). <input type="checkbox"/>
Automatic hose reel, stainless steel, includes swivel holder, 20 m	81	6.392-076.0	Automatic stainless steel hose reel. With swivel holder. Suitable for 20 m high-pressure hose. <input type="checkbox"/>
Automatic stainless steel hose reel, 20 m	82	6.391-520.0	<input type="checkbox"/>
Automatic stainless steel hose reel, 40 m	83	6.392-442.0	Automatic hose reels provide the highest level of safety and convenience for winding and unwinding HP hoses. Compatible high-pressure hose, e.g. order no. 6.110-076.0 (ID 8, 40 m, 400 bar, 1x hose reel connection attachment kit). <input type="checkbox"/>
<b>WET BLASTING ATTACHMENT</b>			
<b>Wet blasting attachment (without nozzle)</b>			
Wet blasting attachment with flow control (without nozzles)	84	4.115-000.0	Paint, rust and scale removal made easy: Kärcher wet blasting attachment with flow control for adding blasting abrasive to the high-pressure jet. <input type="checkbox"/>

Available accessories.



## ACCESSORIES FOR HD 9/20-4 S ST CLASSIC

### 1.367-410.0



		Order no.	Description	
<b>WET BLASTING ATTACHMENT</b>				
<b>Wet blasting attachment (without nozzle)</b>				
Wet blasting attachment without flow control (nozzles not included)	85	4.115-006.0	Addition of spray agent to the high pressure jet. For paint stripping, rust removal and descaling. Assembly on spray lance instead of high-pressure nozzle. Without water flow regulation	<input type="checkbox"/>
<b>Nozzle kits for wet jet unit</b>				
Nozzle kit for wet jet unit 050	86	2.112-023.0	Nozzle kit with wet blasting nozzle and nozzle insert (type specific). For optimal Kärcher wet blasting attachment performance. Only in combination with wet blasting attachment .	<input type="checkbox"/>
<b>Boron carbide nozzle</b>				
Boron carbide nozzle, for machines up to 1,000 l/h	87	6.415-084.0	In addition to nozzle packs. Very wear-resistant nozzle with boron carbide chuck for continuous-duty operation.	<input type="checkbox"/>
<b>DRUM AND TANK CLEANING</b>				
<b>Barrel and tank cleaning</b>				
Barrel cleaner BC 14/12	88	2.112-020.0	The BC 14/12 barrel cleaner is a spray unit for the interior cleaning of containers and barrels - especially oak barrels with a capacity of between 225 and 600 litres.	<input type="checkbox"/>
<b>HKF 50 spray head, brass</b>				
HKF 50 M spray head	89	3.631-039.0	Constant rotational speed and lightweight design: The compact interior cleaning head for cleaning vats and tanks with openings of 50 mm or wider.	<input type="checkbox"/>
	90	3.631-058.0	Compact interior cleaning head for cleaning containers with openings of 50 millimetres or wider. The device stands out from the crowd with its constant rotational speed and lightweight design.	<input type="checkbox"/>
<b>ADD ON KITS</b>				
<b>HP stationary attachment kit</b>				
Add-on kit float	91	2.637-736.0	Float tank for stationary high-pressure middle-class devices for balancing out possible fluctuations in the water flow for a safe separation of machine and tap water. Including wall bracket.	<input type="checkbox"/>
<b>WATER CONNECTION</b>				
<b>Geka coupling</b>				
Geka connector with hose barb, R 1"	92	6.388-465.0	with hose barb	<input type="checkbox"/>
Geka connector with internal thread, R 1"	93	6.388-458.0	with female thread	<input type="checkbox"/>
<b>Water fine filter</b>				
Universal water fine filter, 25 µm	94	2.637-020.0	Water fine filter, mesh size 25 µm, max. temperature 50 °C. Protects the machine from small dirt particles in the water. Water volume up to 1200 l/h. 3/4" connection, with 1" adapter.	<input type="checkbox"/>
Water fine filter, 100 µm, R 1"	95	2.638-270.0	Fine-mesh water filter, 100 µm, max. temperature 60°C. Connects to high-pressure cleaner. Protects the high-pressure cleaner from dirt particles contained in the water. Water flow rate up to 1200 l/h. Connector 1".	<input type="checkbox"/>
<b>Water supply hose</b>				
Water supply hose	96	4.440-270.0	NW 19 R1" / R1", up to 85 °C	<input type="checkbox"/>
<b>Backflow check valve</b>				
Backflow preventer	97	2.641-374.0	To prevent detergent getting into the drinking water cycle in case of inlet at low-pressure. - hot water resistant up to 80 °C - tested according to IEC 60335-2-79 - integrated leakage protection	<input type="checkbox"/>
<b>WASHING BRUSHES</b>				
<b>Rotating washing brush</b>				
Rotating wash brush for > 800 l/h machines, nylon bristles	98	4.113-002.0	Driven by water stream. Gently removes fine dust and traffic film from any surface. Temperature resistant up to 60°C, M 18 × 1.5 (replaceable brush insert).	<input type="checkbox"/>

Available accessories.

## ACCESSORIES FOR HD 9/20-4 S ST CLASSIC 1.367-410.0



99



100

		Order no.	Description	
<b>WASHING BRUSHES</b>				
<b>Rotating washing brush</b>				
Rotating wash brush for > 800 l/h machines, natural bristles	99	4.113-005.0	Driven by water stream. Gently removes fine dust and traffic film from any surface. Temperature resistant up to 60°C, M 18 × 1.5 (replaceable brush insert).	<input type="checkbox"/>
<b>TAKE-OFF POINT EQUIPMENT</b>				
Hose and spray lance holder VA	100	2.042-003.0	Hose and spray lance wall holder for practical and safe storage of high-pressure hoses or spray lances. Stainless steel wall holder.	<input type="checkbox"/>
<b>HIGH PRESSURE</b>				
	101			<input type="checkbox"/>

Available accessories.